

# CLASSIC GRAB BAR

GBMB2, GBMB2A, GBBN2, GBBN2A, GBPC2, GBPC2A, GBBB2, GBBB2A, GBBN3A, GBBN3B, GBBN3C, GBBN3D, GBBN3E, GBBN3F

luca+lex

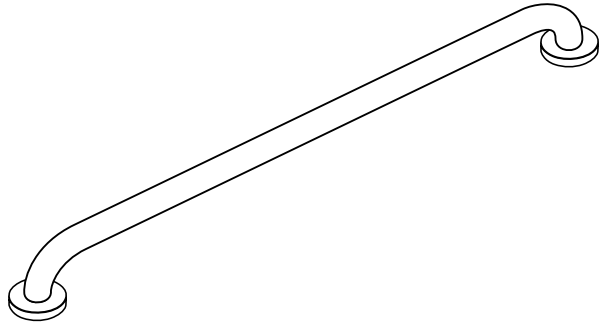

## INCLUDED HARDWARE

Screws

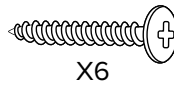

X6

## TOOLS YOU MAY NEED:

Phillips head screwdriver, Hammer, Pencil, Level, Silicone Sealant, Tape Measure, Drill

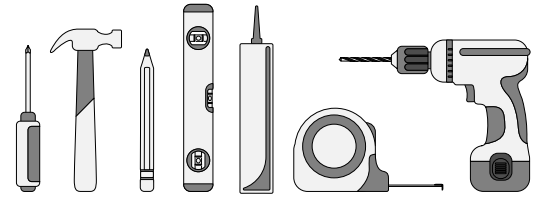

### STEP 1:

- Concealed bracing as specified or required in accordance with local building codes must be installed within wall between studs before wall is finished.

### STEP 2:

- Locate hanging hardware before discarding any packaging.
- Loosen decorative cover plate from wall mount brackets.
- Ensure screws are tightened from wall mount brackets to the towel bar itself.

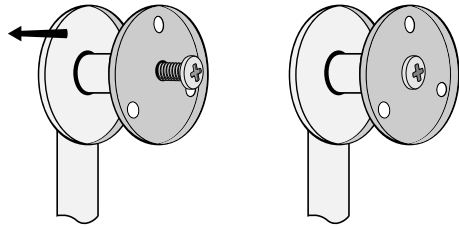

### STEP 3:

- Determine installation location of bracing in the wall.
- Grab bars must always be installed into braces within the wall or wall studs.
- Measure & level the bar in appropriate location

### STEP 4:

- Make sure the wall mount bracket screw holes are visible.
- Mark the anchor and/or screw placement using a pencil through the wall mount brackets.

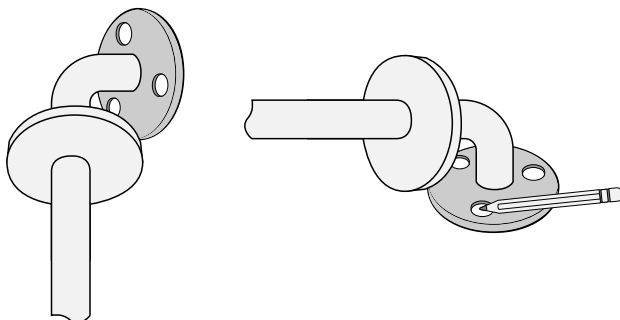

### STEP 5:

- Fasten screws through wall mount bracket.
- Make sure to follow these steps for all holes in wall mount bracket for secure installation

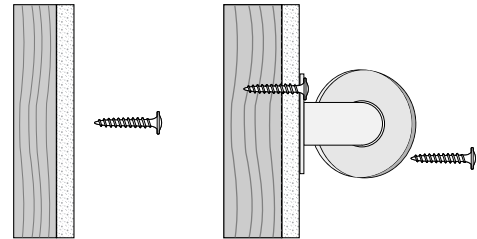

➤ **WARNING:** Grab bars are no stronger than the walls to which they are attached and, therefore, must be firmly secured in order to support the loads for which they are intended. To avoid potential injury, the building owner or maintenance personnel should remove the grab bar from service if the grab bar is not adequately secured to wall or if there is any observed damage.

➤ **WARNING:** For installation to ceramic tile: Apply silicone sealant into the drilled holes before securing the wall plates to the finished surface. This will reduce the risk of water damage behind the finished surface.

➤ **CAUTION:** Risk of property damage. For installation to ceramic tile: Apply light, even pressure to avoid cracking the tile.

➤ This product is considered ADA compliant when located and mounted into a structural support per ADA guidelines. Refer to ADA guidelines before installing this product.

### STEP 6:

- Push decorative cover plate over wall mount bracket for a seamless finish.

